

World Para
Swimming

PARA SWIMMING
WORLD SERIES
FRANCE



TEAMS GUIDE

WELCOME

World Para Swimming in cooperation with Fédération Française Handisport are pleased to share with you the Teams Guide for the Para Swimming World Series France. Within the Guide, you will find all key information relating to the competition.

We look forward to welcoming you to Paris and should you have any questions, please contact the key contacts below

GENERAL INFORMATION

Dates & General Information

Entries open: **03/03**

Classification Entry Deadline: **13/03**

Entry Deadline: **03/04**

Training/Classification Dates: **29/04 -01/05**

Competition Dates: **2- 4/05**

LOC Main Contact: Adrien Vlahovic / a.vlahovic@handisport.org

Accommodation, Catering, Transport : Cloé FURMINIEUX / wps-teamservices@spartner-ec.com

World Para Swimming Technical Delegate: Julian Britez

World Para Swimming Contact: Nicole Burns

Nicole.Burns@WorldParaSwimming.org

World Para Swimming Classification contact: Kanyali Ilako

Kanyali.Ilako@WorldParaSwimming.org

Venue Overview

The competition will be held at The Dôme Saint Germain en Laye. The 1000 seat facility features a 8 lane 50m competition pool, 6 lane 25 m warm up pool.

Location: Le Dôme Saint Germain en Laye – Avenue des Loges, 78100 Saint Germain en Laye

Website : <https://www.dome-78.fr>

Traveling to Paris

Plane

The nearest airports are :

- **Charles de Gaulle Airport (Aéroport de Paris-Charles de Gaulle)** : shuttles/transfers will be provided for delegations arriving at this airport, see prices below. The airport is about 1 hour away from the swimming pool at The Dôme Saint Germain en Laye (close to the hotels).
- **Orly Airport (Aéroport de Paris-Orly)** : shuttles/transfers will be provided for delegations arriving at this airport, see prices below. The airport is about 50 minutes away from the swimming pool at The Dôme Saint Germain en Laye (close to the hotels).

You can follow this link to book your flight <https://www.parisaeroport.fr/>

Train

The nearest train station below are (between 50 minutes and 1 hour and 10 min):

- Gare de Lyon : Pl. Louis Armand, 75012 Paris
- Gare de l'Est : Rue du 8 Mai 1945, 75010 Paris
- Gare du Nord : 18 Rue de Dunkerque, 75010 Paris
- Gare Montparnasse : 5 Pl. des Cinq Martyrs du Lycée Buffon, 75015 Paris
- Gare St Lazare : 109 Rue Saint-Lazare, 75009 Paris
- Gare d'Austerlitz : 85 Quai d'Austerlitz, 75013 Paris
- Gare de Bercy : 52 Bd de Bercy, 75012 Paris

You can follow this link to book your train ticket <https://www.sncf-connect.com/>

Please note that if you arrive at an airport or station other than those listed above, the organizer will not be able to offer you transport. You will have to make your own way to one of the airports or stations listed in order to obtain transportation provided by the organization paid by the delegation. Otherwise, you will have to make your own way to St Germain en Laye.

Visas

Each team is responsible to ensure they have the proper documentation to enter France

Please use the following link to check if you require an entry VISA (<https://france-visas.gouv.fr/fr/web/france-visas/demande-en-ligne>).

Should you require a visa, you can request a letter of support to a.vlahovic@handisport.org with the following information on all staff and athlete's attending from your NPC:

- Full Name
- Position
- Passport Number
- Passport Expiry Date

Accommodation

All below package rates includes accommodation (**rate per room and per day**) with breakfast, lunch and dinner (full-board catering provided), all taxes and shuttle services from the official hotels to the venue.

	Single room	Twin room	Triple room
Double Tree ****	296.00€	434.00€	
Ibis Maisons Laffitte ***	256.00€	393.00€	
Quality Suite Maisons Laffitte ***	244.00€	383.00€	512.00€
Appart city Collection ****	234.00€	366.00€	
HIE Poissy ***	228.00€	356.00€	
Novotel Poissy Orgeval ****	304.00€	453.00€	
Ibis Budget Poissy Orgeval **	229.00€	368.00€	
Mercure Paris Ouest ****	256.00€	375.00€	

Accommodation requests must be made through the official booking website:

www.accommodation-wps2025-france.com

If you encounter a problem on the site, you can contact wps-teamservices@spartner-ec.com

Booking will be definitively confirmed upon full payment reception. Accommodation request and payment must be done before April 3rd.

Cancellations are free of charge before April 3rd. After this date, cancellation will be charged 100%.

Local Transportation

The LOC assures you that you will be taken care of and accompanied from the moment you arrive at the airports and Parisians train stations. Transfers will be done by private car, minibus or coach and adapted vehicle.

Airport/train station transport is an extra cost as per below (**rate is per person, for one way**)

	Number of people		
	1 or 2	From 3 to 5	6 and more
CDG <-> St Germain en Laye	100.00€	80.00€	60.00€
ORY <-> St Germain en Laye	90.00€	70.00€	50.00€
Train station <-> St Germain en Laye	80.00€	60.00€	40.00€

In order to send Airport/train station transportation requests, please fill in the following form and send it to : wps-teamservices@spartner-ec.com

[WPS25 Transport Booking Form.xlsx](#) (Booking form must be submitted before April 3rd)

Competition Fee

Competition Entry fee for athletes: 175€

Entry fee for Staff: 175€

Should an athlete no longer able to attend, withdrawals are as per the WPS Rules and Regulations. Medical Withdrawals require a Medical Withdrawal form submitted to the WPS contact for confirmation.

Payments must be received by **3rd April 2025 maximum**

After 3rd April, no refund will be provided.

To request for invoices, please email Cloé FURMINIEUX (wps-teamservices@spartner-ec.com) with the following details:

- Name of NPC / National Federation
- Billing Address
- Contact Details (Name, telephone number, email address)

Payment for accommodation, transport and fees can be made by bank transfer :

- Name of Bank : CREDIT AGRICOLE CENTRE-EST
- Address of Bank : Centre d’Affaires Sud Rhône, 213 rue de Gerland, Bâtiment A, 69007 Lyon – FRANCE
- Swift Code : AGRIFRPP878
- Beneficiary Name : SPARTNER SAS
- Beneficiary Account : FR76 1780 6008 6904 1322 2022 659
- Beneficiary Address : 14 rue Royale 69001 Lyon – France

SPORT ENTRIES

Entries

All entries must be through WPS Entry system. [SDMS \(ipc-services.org\)](http://SDMS(ipc-services.org))

Important dates

Entries Open: **03/03**

Classification entry deadline: **13/03**

Entry Deadline: **06/04**

All late entries need to be communicated to both LOC and WPS.

LOC will accept entries after the closing date but there will be additional fees of €50 per person and package prices can vary according to remaining availability in the hotels.

The late entries are acceptable until 20th April.

Entries received after the Classification deadline will not receive a classification slot.

Competition Format and Programme

Para Swimming World Series events are run under Multi class competition format for both heats and finals. Points are determined using the World Para Swimming Points System.

For all Para Swimming World Series events the current World Para Swimming Rules and Regulations apply. They can be found on the World Para Swimming website (see Swimming – Rules & Regulations – Rules).

Heats

- 8 lanes will be used
- Heats will be seeded by entry time
- Warm up time: 7.00 am
- Heats start time: 9.00 am

Finals

- 8 lanes will be used
- Finals will be seeded by Points
- Warm up time: 3.00 pm
- Finals start time: 5.00 pm
- The highest points scoring athletes in each event as determined by WPS Points system will be eligible for finals

Finals shall be formatted and prioritized in the following order:

World Series Final A (1-8 Placed on Points)

World Series Youth Final (1-8 placed on points scores of Youth athletes not in the A final).

B Final (9-16 placed on points scores of athletes not involved in youth final)

- Youth and B finals will only take place if more than 4 athletes are eligible for the finals start list.
- Youth Final age group eligibility is 18 years and under (2007 and after)

Finals priority order is outlined below

- Where a swimmer has made the A finals and Youth Final, they will only be entered into the A final. The A final will be prioritised over Youth and B final.
- Where a swimmer has made the B finals and Youth final, they will be only entered into the Youth Final. The Youth final will be prioritised over the B final

If necessary, a swim-off may be used to determine swimmers for an individual final, where point scores are equal, unless the swimmers are the same class then the fastest swimmer shall progress

There will be 2 reserve swimmers for each Finals.

Direct finals will be in place for events with 8 or less entries, as per the WPS Rules and Regulations 10.10.1.2.1.

WPS have implemented an exception to this rule for 50m Breaststroke and 150m Individual medley events to support development of a heat opportunity for lower class athletes.

Version 2 competition programme will be in place for the Para Swimming World Series France. Competition programme below;

Day 1	Day 2	Day 3
100 Freestyle M/F (S1-14)	200m Freestyle M/F (S1-5, S14)	100m Backstroke M/F (S1-2, 6-14)
50 Backstroke M/F (S1-5)	100m Butterfly M/F (S8-14)	50m Freestyle M/F (S1-13)
100m Breaststroke M/F (SB4-9, 11-14)	50m Breaststroke M/F (SB1-3)	400m Freestyle M/F (S6-14)
50m Butterfly M/F (S2-7)	200 IM M/F (SM5-14)	150 IM M/F (SM1-4)
Mixed 4x100 Medley 49pt Relay	Mixed 4x50 Freestyle 20pt Relay	Mixed 4x100 Freestyle S14 Relay
Mixed 4x100 Medley S14 Relay	Mixed 4x100 Freestyle 34pt Relay	Mixed 4x100 Medley 34pt Relay
Mixed 4x50 Medley 20pt Relay	Mixed 4x100 Freestyle 49pt Relay	

Athlete Eligibility

Swimmers must:

Hold an active World Para Swimming license for the Season 2025.

Be entered by their NPC or NF, with the NPC being a good standing member of IPC

Be 12 years of age or older b 31st December in the year of the competition

To compete in Para Swimming World Series finals, an athlete must have an International Classification status of Review (R), Fixed Date Review (FDR) or Confirmed (C).

Any athlete on a New (N) Status not undergoing classification in the competition may only swim in heats and will not progress to finals.

COMPETITION INFORMATION

Competition Venue (more details on technical meeting)

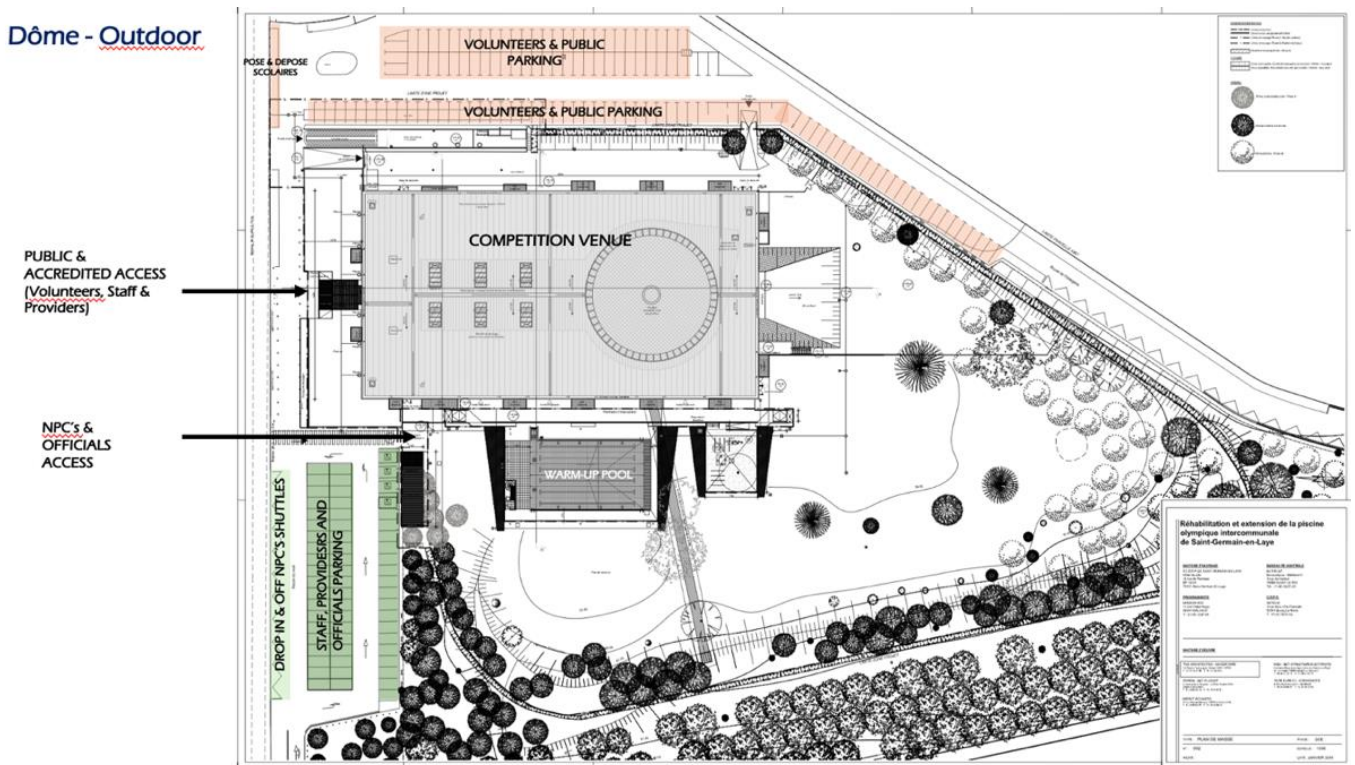

Training

Training on 29th April, 30th April & 1st May dates will take place at Le Dôme Saint Germain en Laye.

Training times will be confirmed after the entry deadline.

A training schedule will be sent to the delegations in the run-up to the event, indicating the time slot available for each delegation, in which pool and at which waterline.

In the competition pool on training days, outside lanes are reserved for classification.

Please note: On the 29th of April training will be held on a 25m pool only.

Warm Up/Swim Down

Warm up on competition days for heats and finals is available in the competition pool and warm up pool.

Warm up times in the competition pool are below:

Heats: 7.00 am to 8.45 am

Finals: 3.00 pm to 4.45 pm

All athletes must follow the warm up signage in place for the safety of all swimmers. Warm up lane allocations will also be shared in the technical meeting.

Swim down in the Warm up pool will close half an hour following the finish of the session.

Technical Meeting

The Technical Meeting will take place 1st May 2025 at 6.00 pm in the Officials Room at Le Dôme Saint Germain en Laye.

Technical Meeting presentation will be circulated to attending NPCs in advance of the meeting to prepare any questions.

Any equipment that is required to be checked by Technical Officials can be taken to the technical meeting and checked at the end of the meeting.

Call Rooms & Competition

There will be only One Call Room in operation in France World Series

1- The Call Room will be located at Level -1 at the competition venue

It is the responsibility of the athlete to report to the Call Room no later than 15 minutes prior to the scheduled start of their event.

Regulations outlined in the World Para Swimming Rules and Regulations concerning swimwear will apply; swimwear (caps, goggles and swimsuits) must be from the approved list and might be checked in the call room. Athletes will be escorted from the Call Room onto the pool deck.

Sport Information Desk (SID)

A Sport Information Desk will operate at the competition venue on the days of competition, as well as during any scheduled training sessions. It is the primary and only point of distribution for all event related information including the following:

- Distribution of start lists for the NPCs;
- Official communication with teams;
- Official forms distribution (Relay Declaration Form, Protest Form, Medical Withdrawal Form);
- Liaison between teams and LOC / World Para Swimming.

Accreditation

All athletes and team staff require accreditation in order to enter the venue and competition areas.

Accreditation registration is through the SDMS system at the following link <https://db.ipc-services.org/accreditation>

Accreditation system open: 03/03

Accreditation registration deadline: 12/04

Classification

This competition offers international classification for the following impairment types:

Physical Impairment (PI) :

Dates : 29th April, 30th April & 1st May 2025

Place : Le Dôme Saint Germain en Laye (Level -2)

Vision Impairment (VI) :

Dates : 29th April, 30th April & 1st May 2025

Place : TBD

World Para Swimming will schedule athletes with a New or Review status pursuant with the below regulations.

An athlete will only be permitted to undergo International Classification if he or she:

Is licensed with World Para Swimming for the 2025 Season.

Has been entered into the competition by the classification entry deadline.

The NPC has submitted their athlete priority list prior to the classification entry deadline.

Has submitted Medical Diagnostics information (Medical Diagnostic Form/TSAL and supporting documents) as requested by WPS to the SDMS by the final entry deadline.

It is NPC responsibility to enter the required events for Classification observation purposes for the athlete in the Entry by Name. Details of which events can be used for observation are found at the following page on the WPS Website. [Para Swimming Classification Rules - Info for NPCs/NFs \(paralympic.org\)](https://www.paralympic.org/para-swimming/classification-rules-info-for-npcs/nfs)

VICTORY CEREMONIES

Medal ceremonies will take place at the end of finals session.

World Series Medals to be awarded to the three highest points scorers in the World Series A Final per event.

World Series Youth Medals to be awarded to the three highest points scorers of youth athletes across all finals per event.

WPS Minus one rule will be implemented where applicable as per the WPS Rules and Regulations.

ANTI-DOPING AND MEDICAL INFORMATION

Anti-Doping

The Anti-Doping control / processes will be carried out in full accordance with the IPC Anti-Doping Code and the IPC Doping Control Agreement.

<https://www.paralympic.org/swimming/rules-and-regulations/anti-doping>

Medical Services at the Venue

Lifeguards, medical team (with 1 competition doctor and 2 nurses) and first aid will be on site for teams.

Insurance

Each NPC must ensure that all members of their delegation are appropriately insured, including coverage for travel, liability, accidents and repatriation. All delegation members must have appropriate accident and health insurance accepted in order to compete. The LOC will provide only basic medical services in the venue

No medical insurance will be provided to any of the participants. All participants are responsible for obtaining their own medical insurance (including Repatriation Coverage) and will be responsible for any medical expenses resulting from participation in the event.

Medical Attention

The following details relate to emergency medical services:

Hospital near accommodation and Venue :

On Google Maps :

Centre hospitalier intercommunal de Poissy - Saint-Germain-en-Laye

20 rue Armagis

78100 Saint-Germain-en-Laye